

# FRACTIONAL HORSEPOWER SERIES

(F.H.P.): MFAL (FIXED BORE A & 4L V-BELT SERIES)



## DID YOU KNOW THAT...

- Stock items include one set screw with standard keyseat

## IMPORTANT REMINDER



**CAUTION: DO NOT** use "A" gripnotch belts ratings with MFAL and MFAM sheaves.

## HOW TO ORDER

EXAMPLE: **MFAL104X3/4**

**M**

**FAL**

**104**

**X3/4**

**M:** MASKA LIGHT DUTY FAMILY

**FAL:** FRACTIONAL HORSEPOWER SERIE

**104:** OUTSIDE DIAMETER (10") (REFER TO THE DIMENSIONS TABLE FOR EXACT VALUE)

**X3/4:** BORE SIZE (3/4")

**DIMENSIONS**

Part No.	List Price \$	Diameter		Stock Bores				Dimensions				Wt (lbs)
		Outside	D.D. A (4L)	5/8"	3/4"	7/8"	1"	F	L	P	C	
MFAL54*	14.88	4.93	4.78	x	x	x	x	19/32	1 1/16	15/32	-	1.1
MFAL64*	15.56	5.93	5.78	x	x	x	x	19/32	1 1/16	15/32	-	1.5
MFAL74*	17.76	6.93	6.78	x	x	x	x	19/32	1 1/16	15/32	-	1.75
MFAL84*	20.24	7.93	7.78	x	x	x	x	19/32	1 1/16	15/32	-	2.2
MFAL94	25.56	8.93	8.78	-	x	x	x	19/32	1 1/16	15/32	-	3.0
MFAL104	28.20	9.93	9.78	-	x	x	x	19/32	1 1/16	15/32	-	2.7
MFAL114	31.20	10.93	10.78	-	x	x	x	19/32	1 1/16	15/32	-	3.1
MFAL124	37.40	11.93	11.78	-	x	x	x	19/32	1 1/16	15/32	-	3.5
MFAM144	61.20	14.16	14.00	-	-	-	x	11/16	1 3/32	13/32	1/32	5.2

\*Note: This item is packaged 10 per carton.  
Pitch Dia. for "A" (4L) belts = Datum Dia. +.26" = O.D. +.11"

SHEAVES

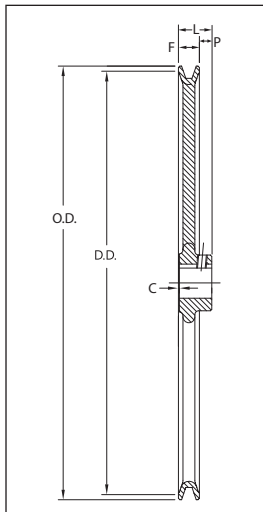

Bore Range	Keyseat
1/2"	None
5/8" - 7/8"	3/16" X 3/32"
15/16" - 1 1/4"	1/4" X 1/8"

